

This slip clutch is being used on Brown Tree Cutters beginning with these serial numbers: Model UOTC60, s.n. 1255; Model BOTC72, s.n. 1289. When this clutch is used, part no. 44-B-A rear drive shaft must be used. It has a 56-NHD yoke in place of the 84-B yoke.

Grove tender

CAUTION: Torque Limiter Adjustment

When spring #GT-124 is compressed, its length should be 1 1/16". When spring is not compressed, its length should be 1 3/16".

When replacing friction disc, measure spring #GT-124, if it measures less than 1 3/16" in length, it should be replaced.

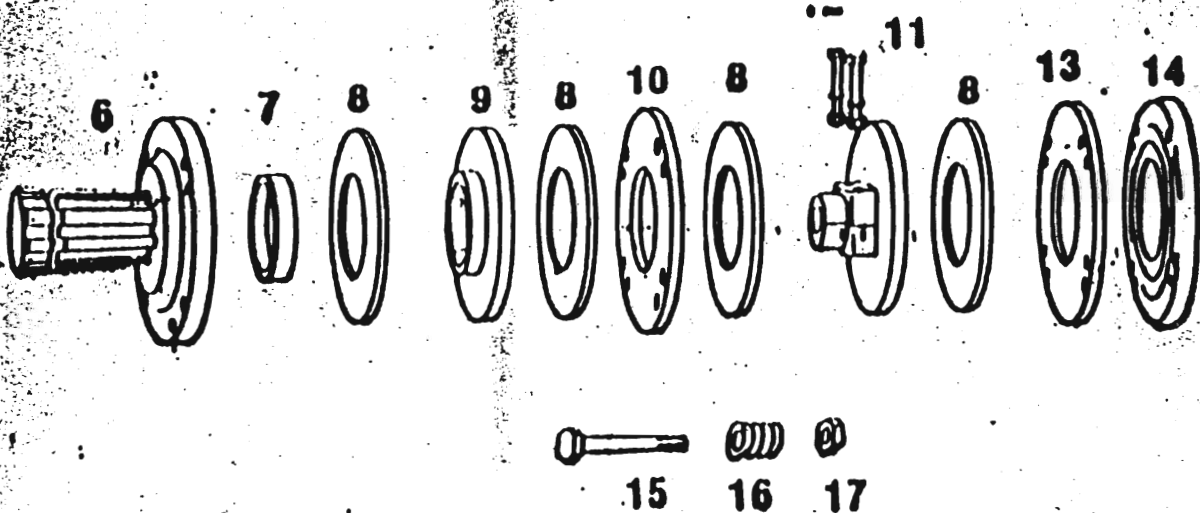

- 6....GT-114 Male sect. torque limiter...
- 7....GT-115 Bushing.....
- 8....GT-116 Friction disc.....
- 9....GT-117 Hex retainer plate.....
- 10....GT-118 Spacer.....
- 11....GT-119 Hub plate.....
- 12....GT-120 Bolt.....
- 13....GT-121 Spacer.....
- 14....GT-122 Backing plate.....
- 15....GT-123 Bolt.....
- 16....GT-124 Spring.....
- 17....GT-125 Nut.....
- GT-127 Torque limiter assy.....